

3. If proper alignment is not obtained with the steps above, the hammer may be bent slightly by removing it from the lock, heating it to a bright red with a torch, and bending it carefully in a vise to obtain the correct alignment.

**WARNING:** Never attempt to alter the position of or remove the barrel bolster (drum) on the Trapper and Kentucky barrels nor the breech plug from any Traditions pistol kit barrel. To do so would create a DANGEROUS unsafe situation as well as void the warranty.

V - Securing Barrel To Stock

- A. Kentucky Pistol only.
- 1. Gently tap rear ramrod thimble (the larger of the two) into ramrod channel until the threaded hole in its side lines up with the hole in the barrel channel of the stock. Enlarge ramrod thimble hole in stock if needed. Insert and tighten ramrod thimble screw through stock and into thimble.
  - 2. Line up threaded hole in front thimble with front hole in barrel channel of the stock. Insert and tighten ramrod thimble screw.
- B. Trapper and Pioneer Pistol.
- 1. If necessary, remove wood from bottom of lock recess until lock is flush with the barrel.
  - 2. With barrel positioned in channel and tang screw loose, insert tenon wedge through stock and tenon. Wedge should fit snugly. Stock opening can be slightly enlarged if necessary. For tighter fit, bend wedge slightly.
- C. Trapper and Kentucky only.
- 1. With barrel in its channel in the stock and tang screw installed but not tightened, attach nose cap with two nose cap screws. Wood should be removed only if necessary, for close fit of nose cap against barrel.
- D. Tighten tang screw.
- E. Trapper only.
- 1. Attach grip cap with grip cap screw.

VI - Trigger Guard Installation

- A. Press rear of trigger guard into inlet in stock. Next align front of trigger guard into its position. It may be necessary to slightly lengthen the cut-out in the stock inlet or to gently bend the guard slightly.
- B. Insert and tighten the two trigger guard screws.

VII - Finishing of Wood and Metal

- A. Using wood rasp, emery cloth and sandpaper, bring wood surfaces flush with metal parts.
- B. Remove metal parts to stain and finish the stock as desired.
- D. Polish brass and bare steel parts with progressively finer grits of emery cloth, Finish with fine grade steel wool.
- E. Brown or blue bare steel parts with chemicals available in most gun shops.

4265I - 1098  
5060I  
5100I

TRADITIONS™  
PERFORMANCE MUZZLELOADING

Assembly Instructions  
Percussion Pistol  
Kits

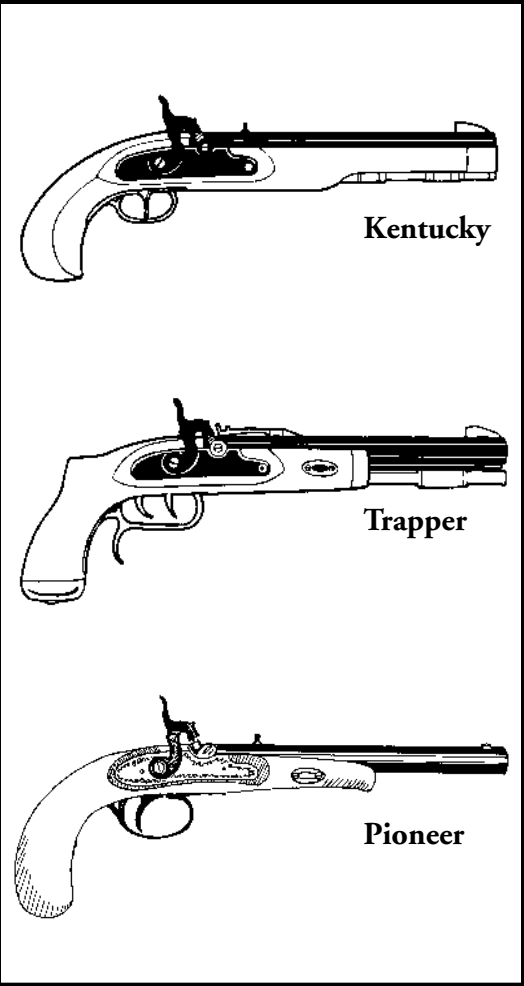

TRADITIONS PERFORMANCE MUZZLELOADING  
P.O. Box 776 • 1375 Boston Post Road  
Old Saybrook, CT 06475-0776  
Phone: (860)-388-4656  
Fax: (860)-388-4657  
e-mail: trad@ct2.nai.net  
www.traditionsmuzzle.com

Kentucky Pistol Kit

KP5060 .50 caliber percussion

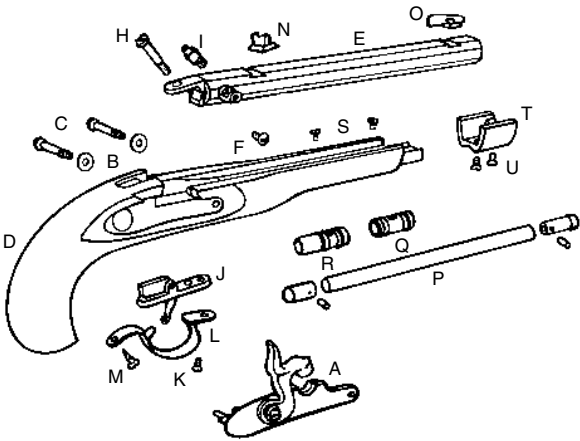

Letter	Description	Number
A	Lock - percussion	20203
B	Lock Plate Washer (2)	20619
C	Lock Plate Screw (2)	20220
D	Stock	10601
E	Barrel Assembly* .50 cal. percussion	C105020
F	Bolster Screw	20605
H	Tang Screw	10409
I	Nipple	20608
J	Trigger Assembly	20222
K	Trigger Assembly/Guard Screw	10435
L	Trigger Guard	10423
M	Trigger Guard Screw	20624
N	Rear Sight	20210
O	Front Sight	20611
P	Ramrod Assembly Ramrod Thimbles:	10628
Q	Front Thimble	10613A
R	Rear Thimble	10613B
S	Ramrod Thimble Screw (2)	20214
T	Nose Cap	10615
U	Nose Cap Screw (2)	20225

\*Barrel sold only as a complete assembly. Bolster not sold separately.

Trapper Pistol Kit

KP5100 .50 caliber percussion

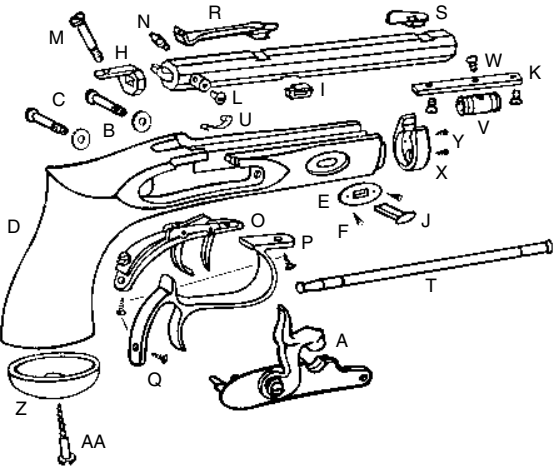

Letter	Description	Number
A	Lock - percussion	20603
B	Lock Plate Washer (2)	20619
C	Lock Plate Screw (2)	20620
D	Stock	11001
E	Stock Plate (2)	20616
F	Stock Plate Screw (4)	20617
G	Barrel Assembly* .50 cal. percussion	C110020
H	Barrel Tang	20606
I	Barrel Tenon	20533
J	Barrel Tenon Wedge	22218
K	Barrel Rib	11012
L	Bolster Screw	20605
M	Tang Screw	20609
N	Nipple	20608
O	Double Set Trigger Assembly	20622P
P	Trigger Guard	11023
Q	Trigger Guard Screw (2+1)	20624
R	Rear Sight Assembly	20610
S	Front Sight	20611
T	Ramrod Assembly	11028
U	Ramrod Spring	20621
V	Ramrod Thimble	20613
W	Thimble/Barrel Rib Screw (3)	20614
X	Nose Cap	11015
Y	Nose Cap Screw (2)	20625
Z	Grip Cap	10826
AA	Grip Cap Screw	10827

\*Barrel sold only as a complete assembly. Bolster not sold separately.

Pioneer Pistol Kit

KP4265 .45 caliber percussion

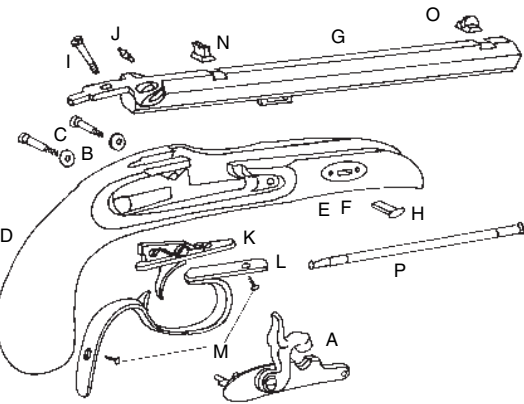

Letter	Description	Number
A	Lock Assembly - Percussion	12603
B	Lock Plate Washer (2)	20840
C	Lock Plate Washer Screw (2) (1 1/2" long machine screw)	20220
D	Stock	12601
E	Stock Plate - installed (2)	21836
F	Stock Plate Screw - installed (4) (3/8" long, wood screw)	21817
G	Barrel Assembly* .45 caliber percussion (1:16")	C126005
H	Barrel Tenon Wedge	12618
I	Tang Screw (1 1/8" long, machine screw)	10109
J	Nipple	20608
K	Trigger Assembly	22222
L	Trigger Guard	12623
M	Trigger Assembly/Guard Screw (2) (9/16" long, wood screw)	20624
N	Rear Sight	20210
O	Front Sight	12611
P	Ramrod Assembly	12628

\*Barrel assembly includes tang and barrel tenon, not sold separately. The barrel assembly is in the white.

Percussion Lock Assembly

12603 - Pioneer Lock Assembly

Letter	Description	Number
A	Lock Plate	70601
C	Mainspring	70505
D	Sear Adjusting Screw Spring	70520
E	Sear Spring	70506
G	Sear Adjusting Screw	70518
H	Hammer Screw	75512
I	Sear Screw	70514
J	Sear Spring & Bridle Screw (2)	70515
N	Hammer	70602
R	Tumbler	70503
S	Sear	70504

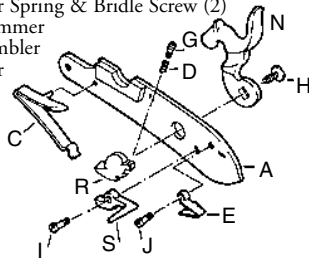

20603 - Trapper Lock Assembly

Letter	Description	Number
A	Lock Plate	70601
C	Mainspring	70505
D	Sear Adjusting Screw Spring	70520
E	Sear Spring	70506
G	Sear Adjusting Screw	70518
H	Hammer Screw	70512
I	Sear Screw	70514
J	Sear Spring & Bridle Screw (2)	70515
N	Hammer	70602
R	Tumbler	70503
S	Sear	70504
T	Bridle	70508
U	Fly	70511

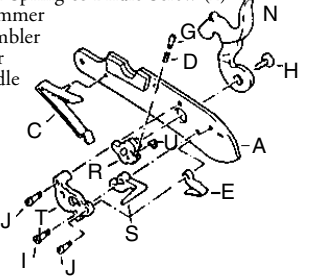

20203 - Kentucky Lock Assembly

Letter	Description	Number
A	Lock Plate	70201
C	Mainspring	70505
D	Sear Adjusting Screw Spring	70520
E	Sear Spring	70506
G	Sear Adjusting Screw	70518
H	Hammer Screw	70512
I	Sear Screw	70514
J	Sear Spring Screw	70521
N	Hammer	70602
R	Tumbler	70103
S	Sear	70504

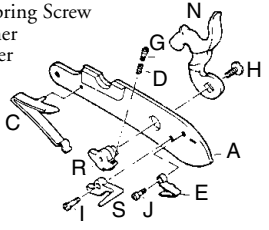

ASSEMBLY INSTRUCTIONS

You are about to build a muzzleloader which will be fully shootable. For this reason it must be handled responsibly and with the same precautions and respect due any firearm. Before loading or shooting your gun, refer to the enclosed booklet *Limited Lifetime Warranty and Shooting Instructions*. Read it completely and carefully and be willing to follow all the instructions and safety precautions at all times. **IMPORTANT: If this companion booklet is not with this kit, contact Traditions for a free copy.**

Before working on your TRADITIONS pistol kit, carefully inspect the component parts and the terms of the Limited Lifetime Warranty in the accompanying booklet. Be aware that the warranty covers only parts of this kit that have not been altered beyond reason.

The following instructions will enable a moderately handy person to build a safe, serviceable and shootable muzzleloader. Your attention to detail and patience will be rewarded with a truly fine replica muzzle-loading firearm.

*Read these instructions thoroughly before beginning assembly.*

Pre-Assembly Instructions

There are three stages to the building of your muzzleloading pistol. Performing each will help insure that you build the best kit you possibly can.

**A.** Before attempting any cutting, drilling, staining, bluing or the like, take all the major components (lock, stock, barrel, trigger, trigger guard, etc.) and roughly fit them together to get a feeling of where they go and how they relate to each other.

**B.** Separate and identify the parts and start the actual assembly of the gun as noted in the following instructions.

Note: Only after all the various parts are fully-inletted, aligned and finally assembled and no additional alterations or sanding to the wood or metal is anticipated, should you attempt to do any staining, finishing or bluing of the wood and metal.

I - Assembly Instructions, General

**A.** All metal parts should fit snugly into their respective cut-out in the stock. Remove a minimum of wood, only if necessary, with a sharp chisel, carving tool, or craft knife. Remove sparingly so as not to remove too much at one time.

**B.** To facilitate assembly and to avoid cracking the stock, small pilot holes should be drilled before inserting wood screws into the stock.

**C.** Turn all metal screws into and out of their respective threaded holes several times to burnish the threads and improve fit.

II - Lock Installation

**A.** Insert lock into its cut-out in the stock.

**B.** Install lock plate screws and washers from left side of gun, through the stock and into their corresponding holes in the lock plate. If holes are not perfectly aligned, enlarge one or both stock holes with a round file or drill to improve alignment. Do not alter the threaded holes in the lock plate. Tighten screws into holes in lock plate. Screws should be flush with the lock plate. File off any excess. Note: For Trapper and Kentucky pistols the ramrod retaining spring must be installed at this time. Place front lock screw and washer

through the left side of the stock then through the hole in the ramrod retaining spring. Position the spring so its belly is curving downward and the flat end is towards the back of the pistol. Note: For a tighter hold on the ramrod, bend spring slightly to increase the curve. For a looser hold, flatten spring slightly to decrease the curve.

III - Barrel Assembly

**A.** Trapper only.

1. Assemble ramrod thimble to the center hole in the barrel rib with one thimble/barrel rib screw.
2. Install rib to the underside of the barrel using remaining two thimble/barrel rib screws.
3. Join barrel tang and barrel, filing barrel hook surfaces as needed for a flush, snug, snap fit.

**B.** Install dovetailed barrel tenon (Trapper) and sights into their respective cut-outs in barrel.

**C.** The barrel tenon (Trapper) and dovetailed sights should fit snugly. If necessary, enlarge dovetail cut-outs in barrel with a triangular file or reduce them slightly by first installing the part then indenting the dovetail surface edges with a hammer and punch.

**D.** Trapper and Kentucky only, screw nipple and clean-out screw into barrel bolster (drum). Pioneer only, screw nipple into snail.

**C.** Set hammer at half-cock.

**E.** Fit barrel (and tang assembly) into stock. The barrel bolster (drum) or snail should be centered in its crescent cut-out in the lock plate. The lock plate, in turn, should be snug against the barrel.

IV - Trigger and Tang Screw Installation

**A.** Check that the tang screw fits smoothly into its corresponding threaded hole in the trigger plate, turning it in and out several times to burnish the threads.

**B.** Place trigger assembly into its stock inlet, sparingly removing wood as necessary so that no moving part touches wood. For Trapper double set trigger assembly, also insure that the wire spring in front of the trigger assembly does not touch any wood.

**C.** Insert the tang screw into the hole in the tang, through the stock and screw it into the trigger assembly. Do not tighten tang screw at this time. Note: In the event that the tang screw needs alignment, enlarge hole in the stock with a round file or drill.

**D.** Trapper only. Insert and tighten the one trigger assembly wood screw.

**E.** IMPORTANT SAFETY PRECAUTION. With lock, barrel and trigger assembled and all screws tightened, the lock hammer should remain securely in its half-cock position, Pulling the trigger should not cause the hammer to fall. The hammer should also remain in the full cock position until the trigger is deliberately pulled. If the lock and trigger do not function properly in both positions, remove the lock and reference the companion *Limited Lifetime Warranty and Shooting Instructions* manual for double set trigger adjustment.

**F.** The hammer should be positioned squarely on the nipple. If it is not, one or more of the following steps may be taken:

1. Remove wood from bottom of lock recess until lock is flush with the barrel.
2. Remove wood as needed from under and behind the barrel channel, including tang area.