

Dist-inject

The gas rifle model 70 & 72

This model is fitted with a steel barrel of 13 mm diameter which means that all conventional metal syringes as well as „Speedy“ disposable syringes can be fired.

The standard accessories for this model include also an aluminium insertion plug-on barrel of 11 mm diameter, with which all smaller plastic syringes can be used.

The barrel is fitted to the gun with or without the plug-on barrel, depending on the type of syringes which is used.

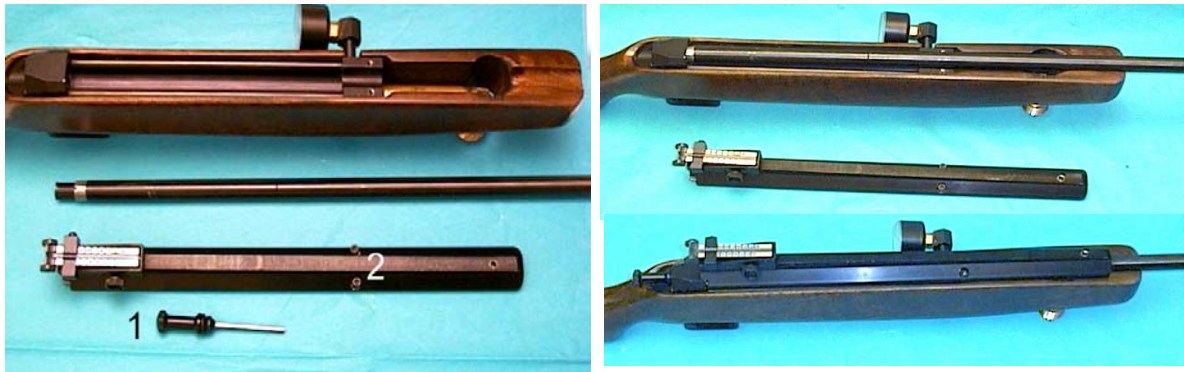

Setting in the barrel

Slightly loosen the two screws on the cover plate **no.2** by using the hexagonal key on the plug **no.1**, so that the indentation at the rear of the barrel engages into the pin at the inner side of the rifle's rear block. Then retighten the both screws on the plate.

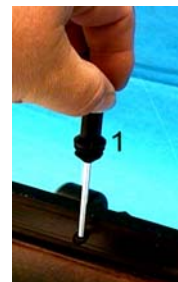

Insertion of the syringe.

Remove the plug **no.1** and insert the syringe into the barrel. Relock the barrel with the plug which serves at the same time as positioner for the inserted syringe

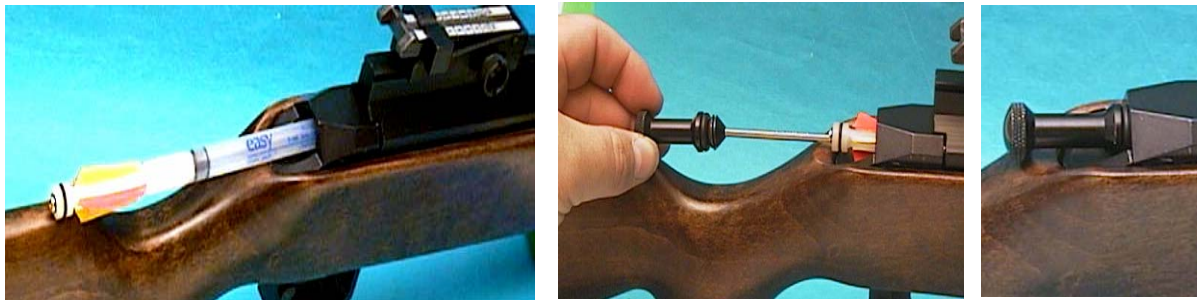

Safety

Make sure that the pressure regulating button is set at the neutral position that is in the centre between - **minus** and + **plus**, thereby assuring that the gun has been neutralized. This is the case when the red mark on the safety button is **not** longer visible

Attention ! Before changing the capsule, release the residual pressure until the gauge shows zero.



Dist-inject

Charging the CO₂

The supplied black holder Nr.6 is intended for 16 g capsules. When using the 8 g household capsules use the grey insert.

Screw the charged holder now on the valve Nr.5.

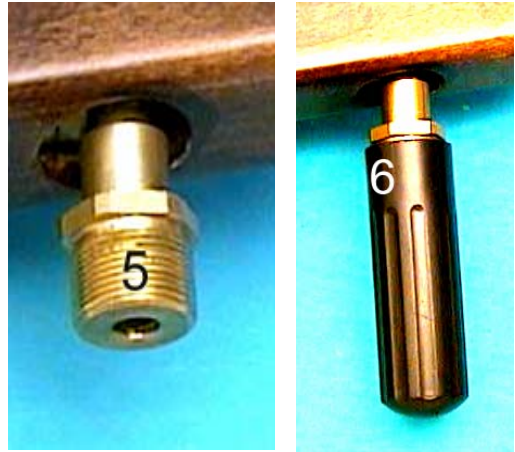

Pressure regulation

Set the pressure required by turning the pressure regulations button in the direction **+ plus** while at the same time check the pressure gauge. If the gas pressure is too high, it can be reduced by rotating the button in the direction **- minus** and stabilizing it in any desired position.



Attention before changing the capsule, release the residual pressure until the gauge shows zero.

The shooting table enclosed provides a number of pointers to pressure settings, and, as a function of the pressure, to the sight adjustment at varying ranges and with different types of syringes. If the gun is not used for a prolonged period after firing, it is advisable to release the residual gas pressure and remove the empty capsule from the valve.

Using the foot pump

Remove the washer at the valve no.5, unscrew and remove the capsule opener no.8. Replace it by the quick coupling part no.9 by setting the supplied washer.

Set the gun on safety as shown before.

Put now the quick coupling part on the flexible tube of the foot pump into the female coupling part of the valve and set the pressure regulation knob on position **+ plus**.



Activate the pump by controlling the pressure gauge. When the desired pressure is reached, turn the pressure regulation knob on neutral and remove the flexible tube from the valve.

Important.
Put the safety knob no.4 on fire direct before shooting only.