

- Hawken Woodsman Rifle (Brass) -

Models:

Finished

Kit

R-2390	R-2390801	R-2395	R-2405	R-2400	R-24008	R-24048	KR-5245
.50 cal. flint. 1-66"	.50 cal. flint. 1-48"	.45 cal. flint. 1-66"	.45 cal. perc. 1-66"	.50 cal. perc. 1-66"	.50 cal. perc. 1-48"	.54 cal. perc. 1-48"	.45 cal. perc. 1-66"
Blued Barrel	Blued Barrel	Blued Barrel	Blued Barrel	Blued Barrel	Blued Barrel	Blued Barrel	Blued Barrel

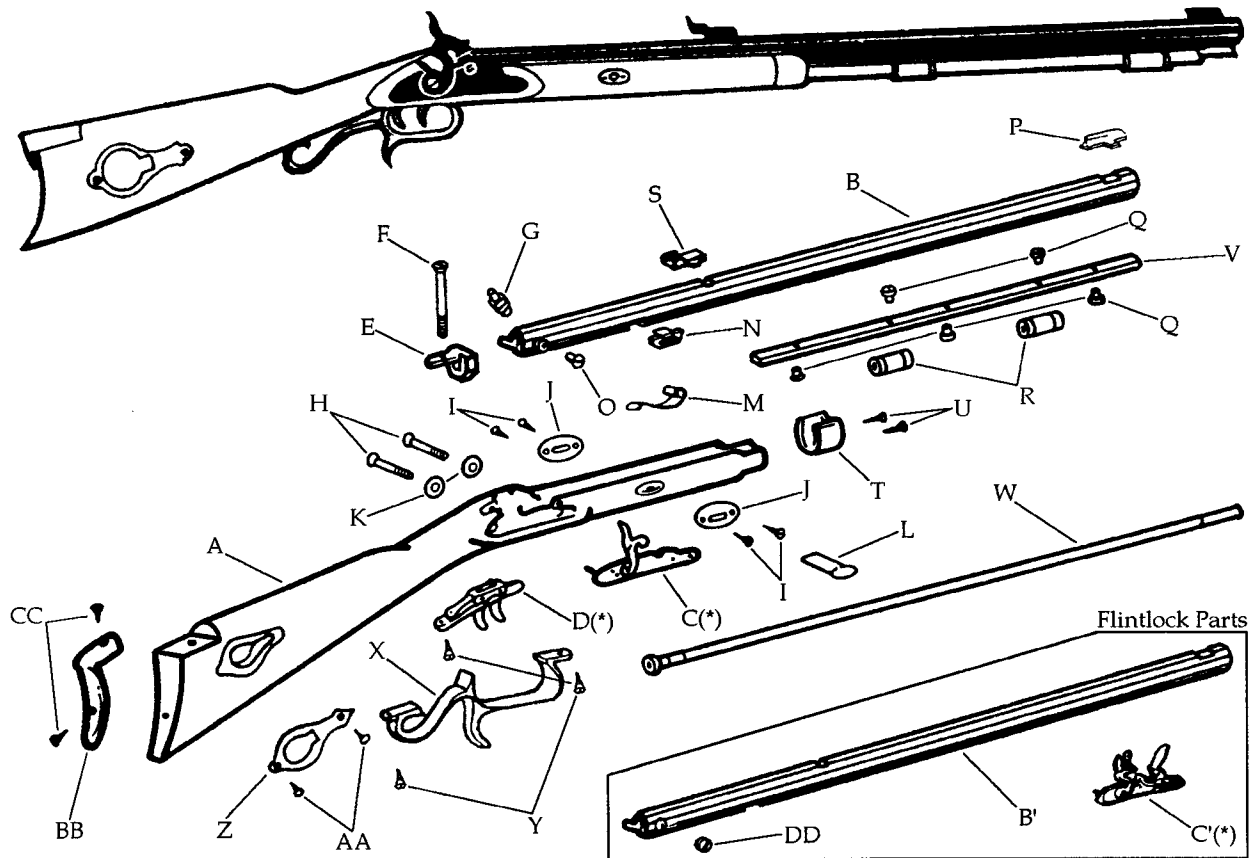

Description	Reference	Description	Reference
A Stock Beech (Kit).....	K-24001	G Nipple Percussion Only.....	20608
Stock Beech Flintlock (Finished).....	FCS23901	H Lock Plate Screw (2).....	20120
Stock Beech Percussion (Finished).....	FCS24001	I Stock Plate Screw (4).....	20617
B Barrel Assembly (Kit) (Length 28")		J Stock Plate (2) (Brass).....	22216L
.45 cal. perc. Blued (twist 1-66").....	C-240025	K Lock Plate Washer (2).....	20840
.50 cal. perc. Blued (twist 1-66").....	C-240020	L Barrel Tennon Wedge.....	22218-2
.50 cal. perc. Blued (twist 1-48").....	C-240080	M Ramrod Retaining Spring.....	20621
.54 cal. perc. Blued (twist 1-48").....	C-240048	N Barrel Tennon.....	20533
Barrel Assembly (Finished) (Length 28")		O Bolster Screw -Percussion Only.....	20605
.45 cal. perc. Blued (twist 1-66").....	FB240025	P Front Sight.....	30611
.50 cal. perc. Blued (twist 1-66").....	FB240020	P' Front Sight (45 cal. Only).....	20611
.50 cal. perc. Blued (twist 1-48").....	FB240080	Q Thimble/Barrel Rib Screw (5).....	20614
.54 cal. perc. Blued (twist 1-48").....	FB240048	R Ramrod Thimble (2) (Brass).....	20613
B' Barrel Assembly (Kit) (Length 28")		S Rear Sight.....	40610
.45 cal. flint. Blued (twist 1-66").....	C-239025	S' Rear Sight (45 cal. Only).....	22810
.50 cal. flint. Blued (twist 1-48").....	C-239080	T Nose Cap (Brass).....	24015
.50 cal. flint. Blued (twist 1-66").....	C-239020	U Nose Cap Screw (2).....	20627
Barrel Assembly (Finished) (Length 28")		V Barrel Rib.....	24012
.45 cal. flint. Blued (twist 1-66").....	FB239025	W Ramrod Assembly (Synthetic).....	22228M
.50 cal. flint. Blued (twist 1-48").....	FB239080	X Trigger Guard (Brass).....	20823
.50 cal. flint. Blued (twist 1-66").....	FB239020	Y Trigger Guard Screw (3).....	20624
C Percussion Lock.....	20803	Z Patchbox (Brass).....	20435
C' Flintlock.....	20703	AA Patchbox Screw (2).....	400024
D Trigger Assembly.....	20622R	BB Butt Plate (Brass).....	24026
E Barrel Tang.....	20606	CC Butt Plate Screw (2).....	20627
F Tang Screw.....	20609	DD Touch Hole Insert -Flintlock Only.....	20534

(*) Exploded view at the reverse.

TRADITIONS™

Flintlock Assembly - Ref. 20703

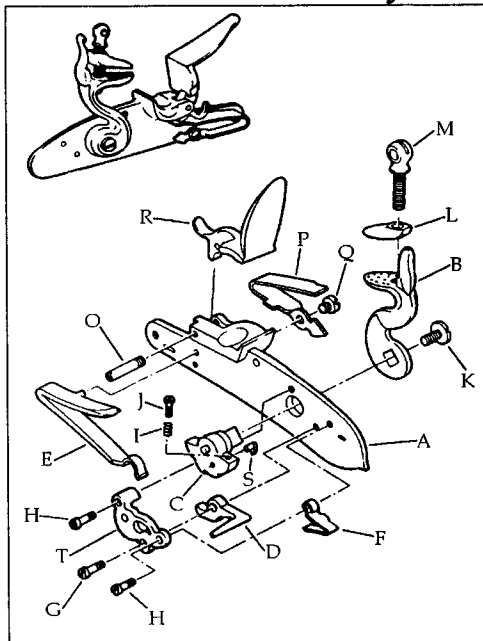

Description		Reference
A	Lock Plate.....	70601
B	Hammer.....	70302
C	Tumbler.....	70503
D	Sear.....	70504
E	Mainspring.....	70505
F	Sear Spring.....	70506
G	Sear Screw.....	70514
H	Sear Spring & Bridle Screw (2).....	70515
I	Sear Adjusting Screw Spring.....	70520
J	Sear Adjusting Screw.....	70518
K	Hammer Screw.....	75512
L	Top Jaw.....	70309
M	Top Jaw Screw.....	70513L
O	Frizzen Screw.....	70516
P	Frizzen Spring.....	70519
Q	Frizzen Spring Screw.....	70517
R	Frizzen.....	70507
S	Fly.....	70511
T	Bridle.....	70508

Percussion Lock Assembly - Ref. 20803

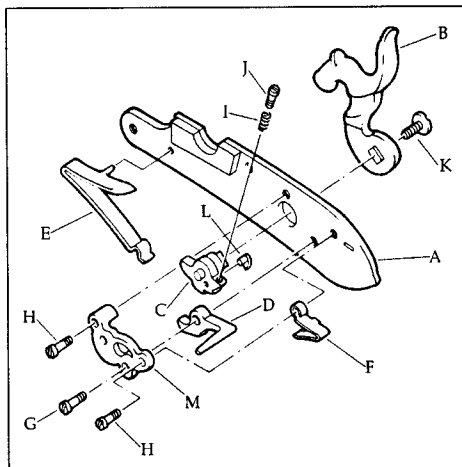

Description		Reference
A	Lock Plate.....	70801-I
B	Hammer.....	70802
C	Tumbler.....	70503
D	Sear.....	70504
E	Mainspring.....	70505
F	Sear Spring.....	70506
G	Sear Screw.....	70514
H	Sear Spring & Bridle Screw (2).....	70515
I	Sear Adjusting Screw Spring.....	70520
J	Sear Adjusting Screw.....	70518
K	Hammer Screw.....	75512P
L	Fly.....	70511
M	Bridle.....	70508

Trigger Assembly - Ref. 20622R

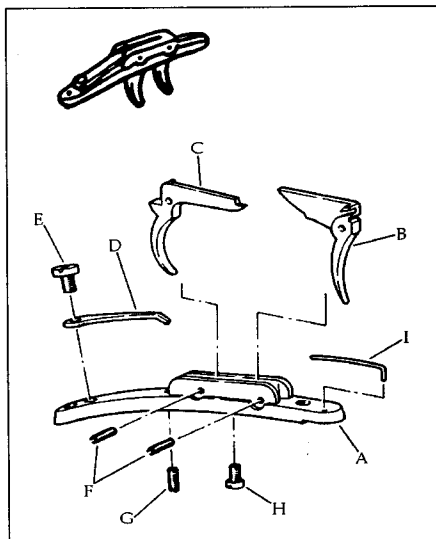

Description		Reference
A	Trigger Plate.....	60601R
B	Front Trigger.....	60602
C	Rear Trigger.....	60603
D	Rear Spring.....	60604R
E	Rear Spring Screw.....	60606
F	Trigger Pin (2).....	60609
G	Rear Trigger Adjustment Screw.....	60608
H	Front Trigger Adjustment Screw.....	60607
I	Front Spring.....	60605